

# DOG PARK SUBCOMMITTEE SPECIAL MEETING

January 12, 2017

Pursuant to the direction of Co-Chairman John Rich, the Dog Park Subcommittee of the Stratford Parks & Recreation Committee will conduct a special meeting on Thursday, January 12, 2017 in Council Chambers of Stratford Town Hall, 2725 Main Street, Stratford CT, at 7:00pm.

## AGENDA

I CALL TO ORDER

II OPEN PUBLIC FORUM

Possible sites for Stratford Dog Park

- Boothe Park (2 sites)
- Great Meadows Park
- Longbrook Park (2 sites)
- Roosevelt Forest
- Short Beach

III ADJOURNMENT

**NOTE: Attached to this document are copies of maps indicating the possible sites within the above listed locations. (These maps are not drawn to scale.)**

Any individual with a disability who needs special assistance to participate in the meeting should contact ADA Coordinator at 385-4020 (TDD) 5 days before the meeting.

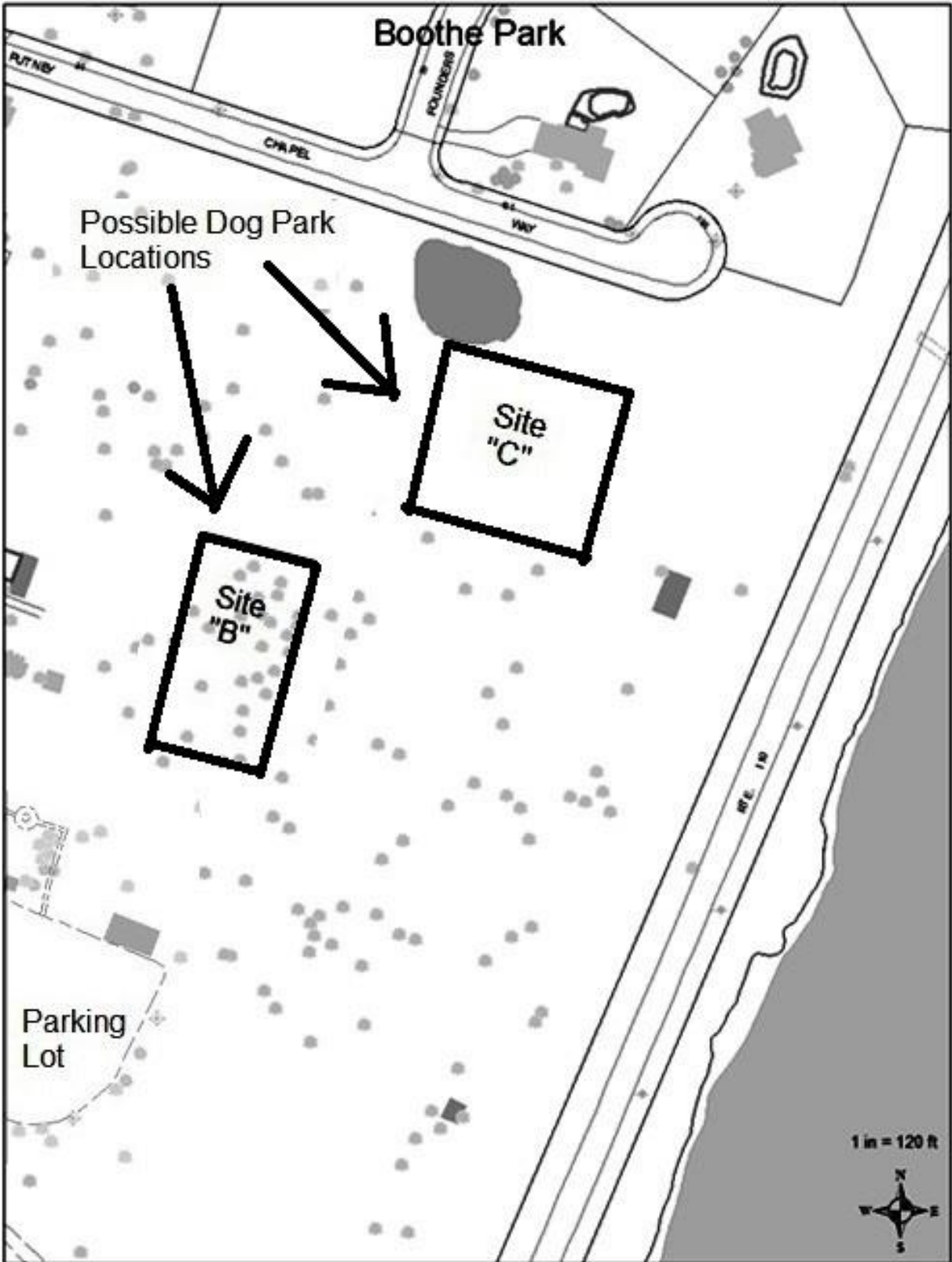

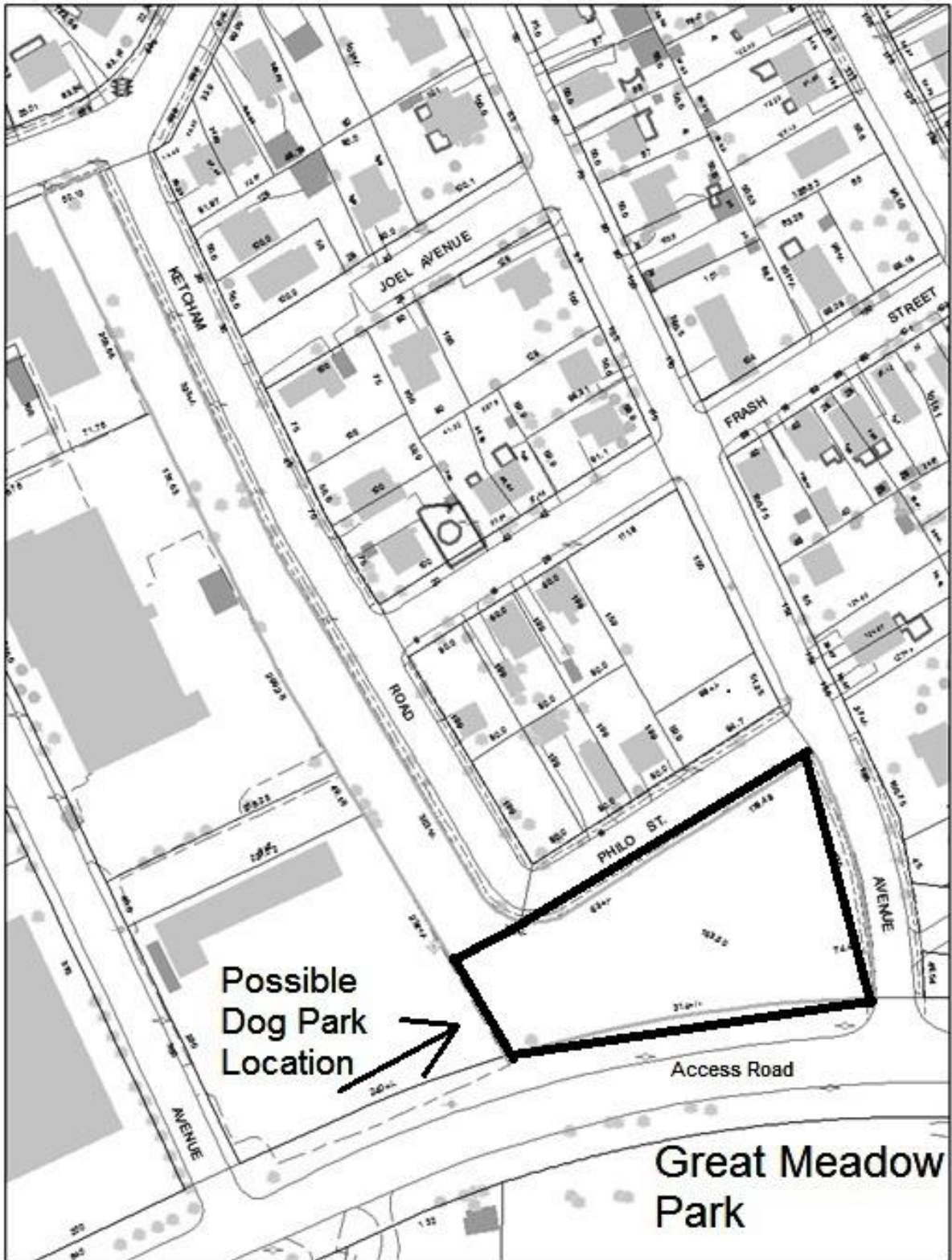

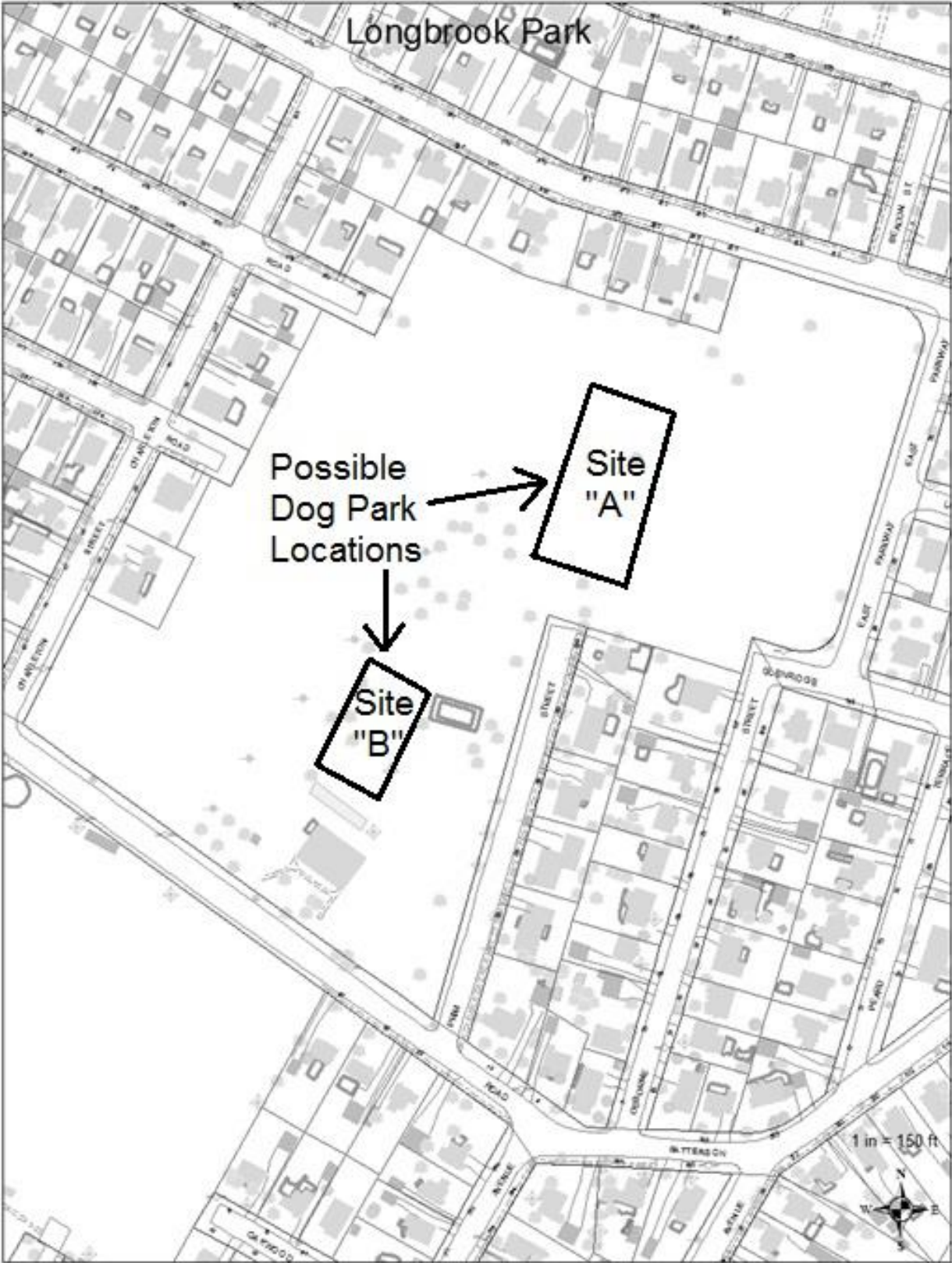

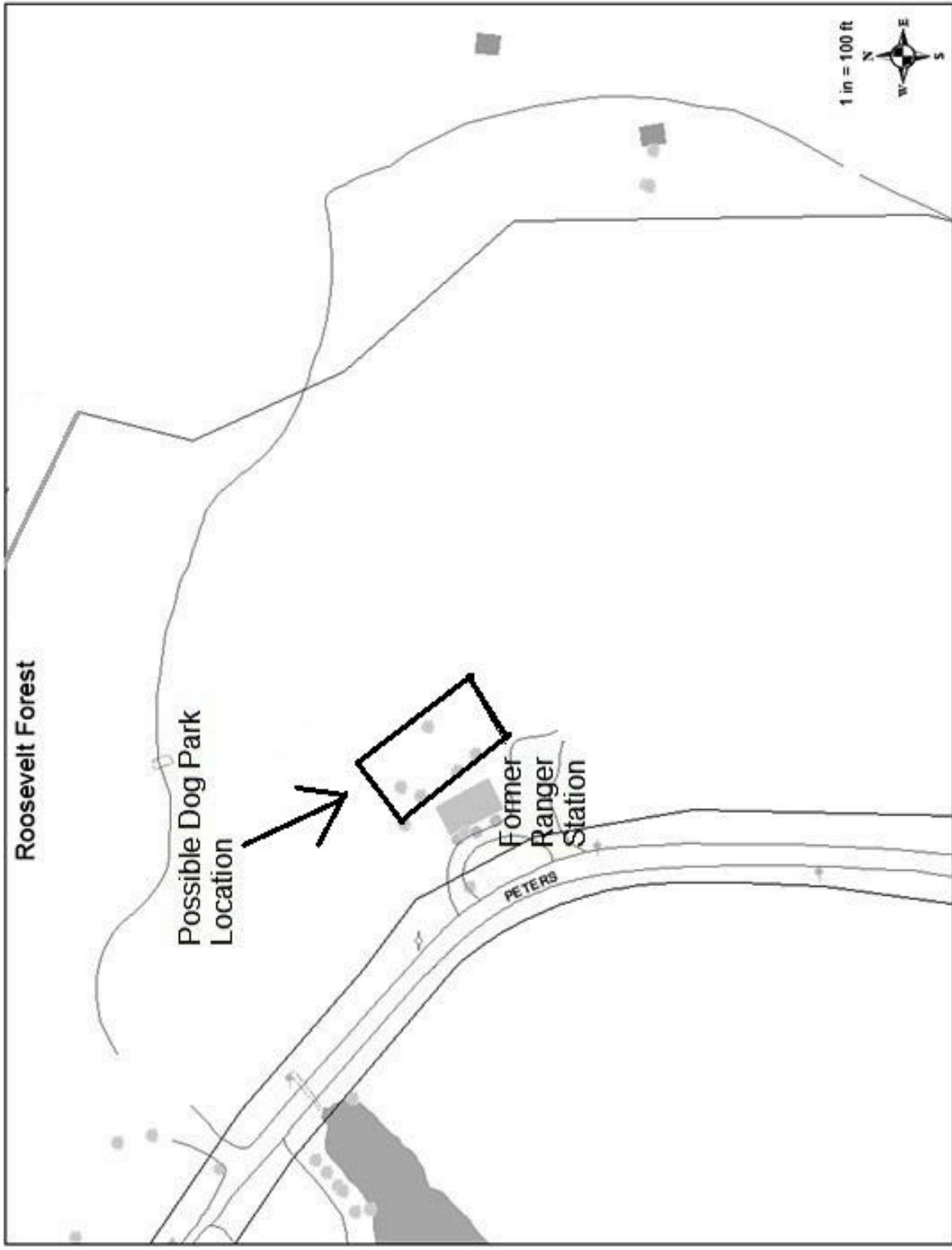

Short Beach

Dorne Drive

Possible  
Dog Park  
Location



Site  
of  
Former  
Miniature  
Golf  
Course

1 in = 80 ft

