

New Railings at: Wilcoxson Elementary School

600 Wilcoxson Avenue
Stratford, CT 06614



2725 Main Street
Stratford, CT 06614

LOCATION MAP

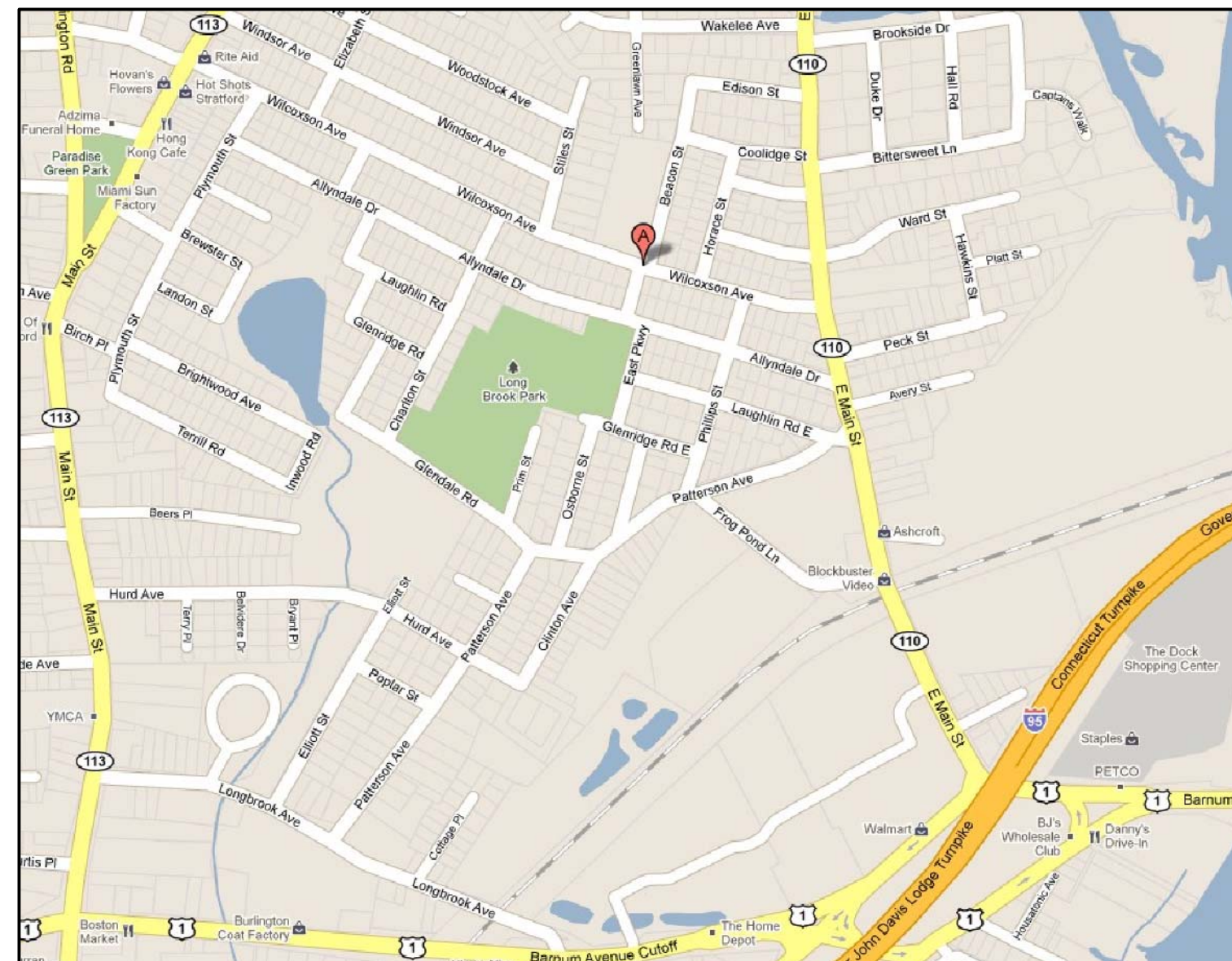

GENERAL NOTES:

- ALL DETAILS AND/OR PART OF DETAILS ARE SIMILAR FOR SIMILAR LOCATIONS IN ALL OR PART OF THE DETAIL.
- ALL WORK IS NEW UNLESS NOTED OTHERWISE.
- EACH CONTRACTOR SHALL VERIFY ALL CONDITIONS AND DIMENSIONS ON THE JOB SITE.
- INDICATED DIMENSIONS ARE TO :
A. FACE OF MASONRY OR CONCRETE AND FACE OF FINISH TO FINISH ARE EXACT.
B. CENTER LINES.
- WRITTEN DIMENSIONS ON THESE DRAWINGS SHALL HAVE PRECEDENCE OVER SCALED DIMENSIONS.
- ANY VARIATION FROM CONDITIONS SHOWN ON THESE DRAWINGS SHALL BE BROUGHT TO THE ATTENTION OF THE CONSTRUCTION MANAGER AND ARCHITECT. AFFECTED WORK SHALL NOT PROCEED UNTIL CLARIFICATION HAS BEEN RECEIVED.
- ALL WORK IS TO CONFORM TO ALL APPLICABLE CONNECTICUT BUILDING CODES.
- USE ONLY NEW MATERIALS AND EQUIPMENT WITHOUT DEFECTS.
- DISCREPANCIES AND OMISSIONS ON DRAWINGS AND SPECIFICATIONS SHALL BE REPORTED TO THE CONSTRUCTION MANAGER AND ARCHITECT IN WRITING FOR CLARIFICATION.
- SET ALL WORK STRAIGHT, PLUMB AND LEVEL OR WITH INDICATED SLOPE.
- EACH CONTRACTOR IS TO USE THE APPROVED STANDARDS: A.I.S.C. FEDERAL, U.S., ETC. STANDARDS OF THEIR TRADES. ALL CONSTRUCTION SHALL BE PERFORMED TO THESE STANDARDS.
- IF AMBIGUITIES EXIST IN THE CONTRACT DOCUMENTS, THE CONTRACTOR SHALL INCLUDE IN HIS BID THE MORE EXPENSIVE METHOD OF WORK.
- THE GENERAL CONTRACTOR SHALL REMOVE AND DISPOSE OF ALL DEBRIS.
- LARGE SCALE DETAILS HAVE PRECEDENCE, HOWEVER WORK INDICATED ON SMALL SCALE DRAWINGS SHALL NOT BE OMITTED. SIMILARLY, NOTES TAKE PRECEDENCE OVER SCHEDULES, PIPING AND WIRE DIAGRAMS. HOWEVER WORK SHOWN OR DESCRIBED BY OTHER METHODS SHALL NOT BE OMITTED.
- CUT AND PATCH ALL EXISTING FINISHES AS REQUIRED BY NEW WORK. MATCH AND FINISH TO PRESENT FINISHED SURFACES OR AS INDICATED.
- FLASH PATCH EXISTING CONCRETE SLABS THAT ARE TO RECEIVE FINISH FLOORING AS REQUIRED.
- ALL PIPING IN FINISHED SPACES TO BE FURRED OUT AND FINISHED TO MATCH EXISTING ADJACENT FINISHES.
- BY SUBMISSION OF THE BID OR PROPOSAL THE UNDERSIGNED BIDDER AND THE PERSON OR PERSONS SIGNING ON BEHALF OF THE BIDDER, AND SHOULD THIS BID BE A JOINT BID, EACH PARTY THERETO, CERTIFIES AS TO ITS OWN ORGANIZATION, UNDER PENALTY OF PERJURY, THAT TO THE BEST OF KNOWLEDGE AND BELIEF:

THE PRICES IN THIS BID HAVE BEEN ARRIVED AT INDEPENDENTLY WITHOUT COLLUSION, CONSULTATION, COMMUNICATION, OR AGREEMENT FOR THE PURPOSE OF RESTRICTING COMPETITION, AS TO ANY MATTER RELATING TO SUCH PRICES WITH ANY OTHER BIDDER OR WITH ANY COMPETITOR.

UNLESS OTHERWISE REQUIRED BY LAW, THE PRICES WHICH HAVE BEEN QUOTED IN THIS BID HAVE NOT BEEN KNOWINGLY DISCLOSED BY THE BIDDER PRIOR TO OPENING, DIRECTLY OR INDIRECTLY, TO ANY OTHER BIDDER NOR TO ANY COMPETITOR; AND NO ATTEMPT HAS BEEN MADE OR WILL BE MADE BY THE BIDDER TO INDUCE ANY OTHER PERSON, PARTNERSHIP OR CORPORATION TO SUBMIT OR NOT TO SUBMIT A BID FOR THE PURPOSE OF RESTRICTING COMPETITION.

LIST OF DRAWINGS

ARCHITECTURAL

- T-1 TITLE SHEET
C-1 DRAINAGE IMPROVEMENT PLAN

Revisions

8/20/2010	ISSUED TO CLIENT
2/28/2011	ISSUED FOR BID

The Geddiss Partnership

Architecture Planning Interiors
71 Old Post Road, Southport, CT 06890
(203) 256-8700

Project



2725 Main Street
Stratford, CT 06614

New Railings at: Wilcoxson Elementary School

600 Wilcoxson Avenue
Stratford, CT 06614

Drawing Title

TITLE SHEET

MATERIALS LEGEND:

	BRICK		STONE
	BATT INSULATION		CRUSHED STONE
	CONTINUOUS WOOD FRAMING THROUGH MEMBER.		CONCRETE MASONRY UNITS
	CONCRETE		NEW PARTITION
	METALS		WOOD FRAMING - INTERRUPTED MEMBER
	PARTICLE BOARD		FINISHED WOOD
	RIGID INSULATION		
	COMPACTED GRAVEL		
	EARTH/UNDISTURBED SOIL		

GRAPHIC LEGEND:

	INTERIOR WALL ELEVATION NUMBERS		REMOVE EXISTING CONSTRUCTION
	SECTION REFERENCE		REVISION MARK
	DETAIL REFERENCE		COLUMN GRID LINES
	ROOM NUMBER		BUILDING SECTION
	CEILING HEIGHT		INDICATES HIDDEN LINE - ABOVE, BELOW, BEHIND OR ITEMS TO BE REMOVED
	PARTITION TYPE		EXISTING DOOR ASSEMBLY
	EXTERIOR ELEVATIONS		EXISTING DOOR TO BE REMOVED
	CENTERLINE OR N.I.C.		DOOR TO BE INSTALLED - INDICATES DOOR NUMBER (SEE SCHEDULE)
	WINDOW TYPE		FURNITURE
	HOLLOW METAL TYPE		

NOTE: ROOM NUMBERS DESIGNATED DO NOT CORRESPOND TO EXISTING SCHOOL SIGNAGE & ARE FOR CONSTRUCTION PURPOSE ONLY

Issued 2/28/2011

Scale AS INDICATED

Job No. 6400.1021

Drawing No.

T-1

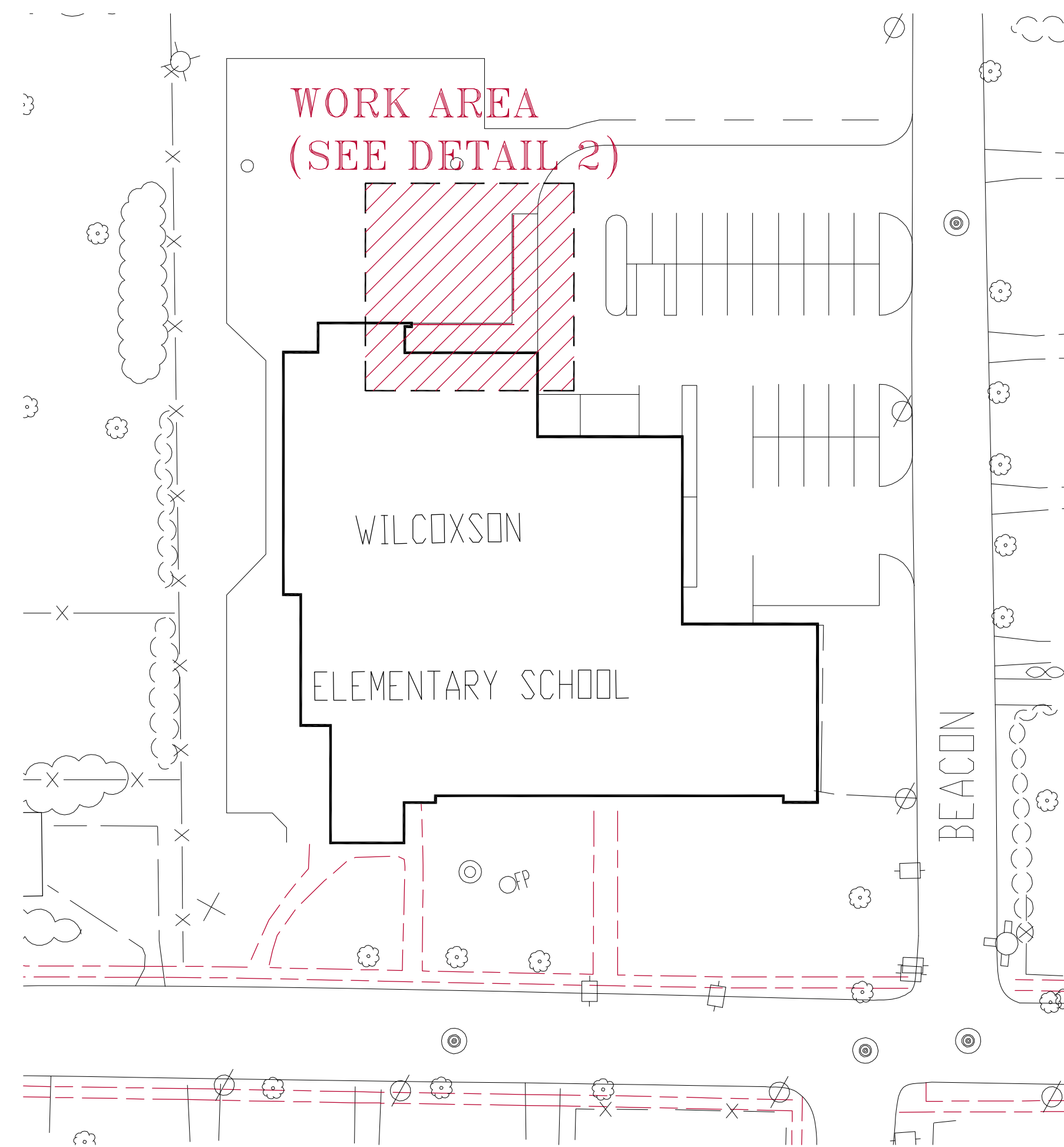

1 KEY PLAN

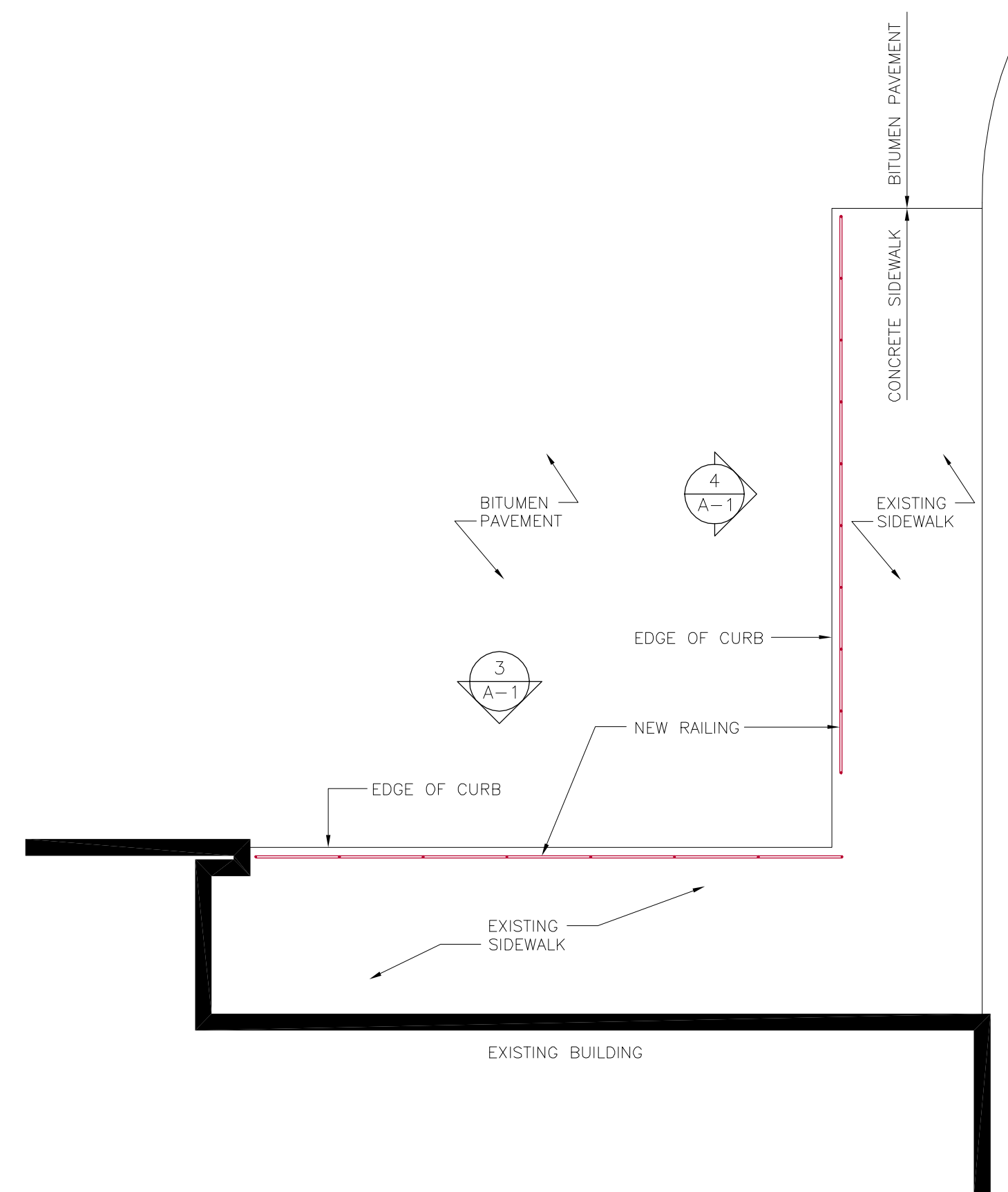

2 PARTIAL PLAN

GENERAL NOTES

GENERAL:

- All details shall be considered typical and shall apply at all same and similar conditions.
- The Contractor shall field measure and verify all dimensions of the existing building and all dimensions related thereto.
- All work shall be in accordance with Connecticut State Building Code (CSBC) which includes the 2003 International Building Code, the 2005 Connecticut Supplement.
- The Contractor shall be solely responsible for construction site safety.
- Contractor shall provide ADD ALTERNATE price to provide stainless steel railings in lieu of hot dipped galvanized.

PIPE AND TUBE RAILINGS

- SUMMARY
 BASEID: Hot-dipped galvanized steel railings: Galvanized after fabrication
 ADD ALTERNATE: Stainless-steel pipe and tube railings, Type 304 316L.
- PERFORMANCE REQUIREMENTS
 A. Engineering design of railings by Contractor.
 Structural Performance: Railings shall withstand the effects of gravity loads and the following loads and stresses within limits and under conditions indicated:
 - Handrails and Top Rails of Guards:
 - Uniform load of 50 lbf/ft. applied in any direction.
 - Concentrated load of 200 lbf applied in any direction.
 Pipe: ASTM A 53/A 53M, Type F or Type S, Grade A, Standard Weight (Schedule 40), unless another grade and weight are required by structural loads.
- FABRICATION
 A. Changes in Direction of Members: By bending.
 B. Connections: Welded smooth and level with adjacent surface to provide finished appearance.
- FINISHES
 A. BASEID: Hot-dipped galvanized steel: Galvanized after fabrication.
 B. ADD ALTERNATE: Stainless Steel: Dull satin, No. 6.

BASEID / ALTERNATES:

BASEID: All railings shall be 1 1/2" diameter hot-dipped galvanized steel.

ADD ALTERNATE: All railings shall be 1 1/2" diameter stainless steel, Type 304-316L, dull satin, No. 6 finish.

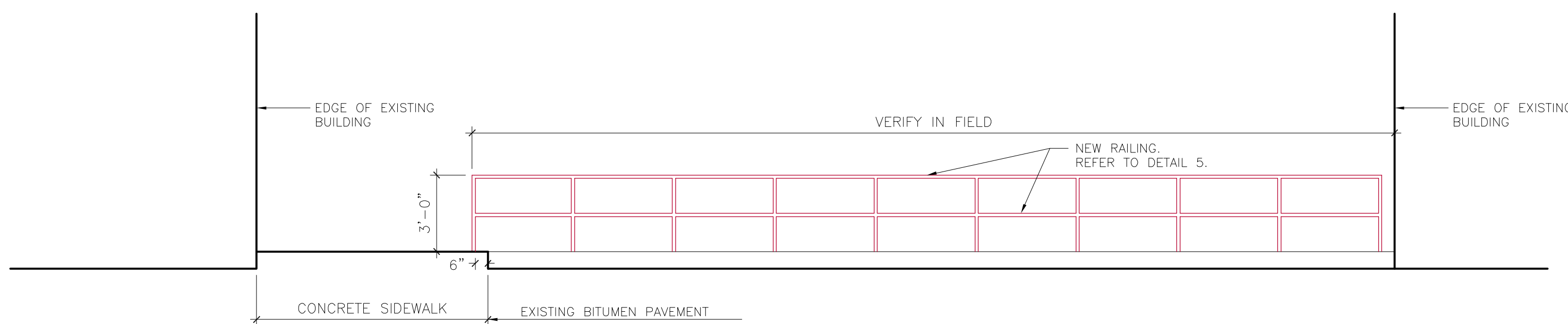

3 ELEVATION

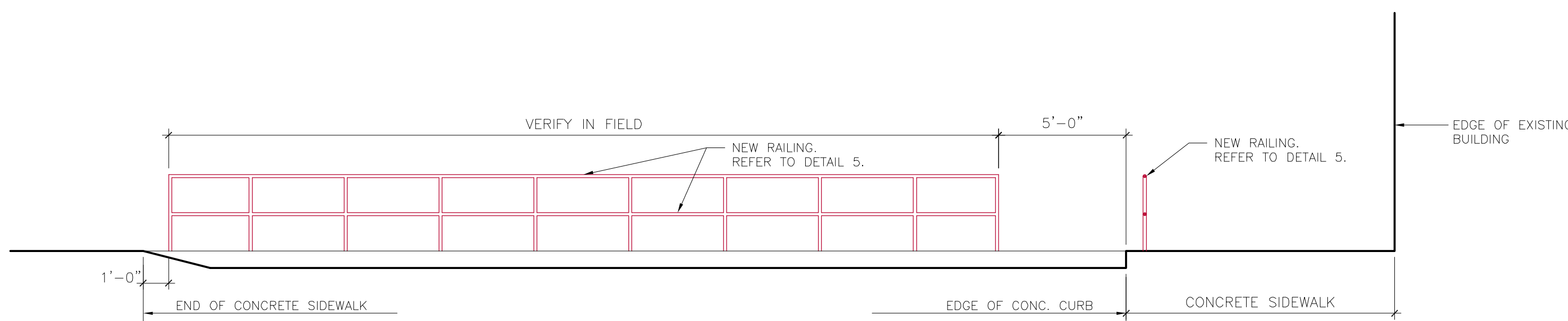

4 ELEVATION

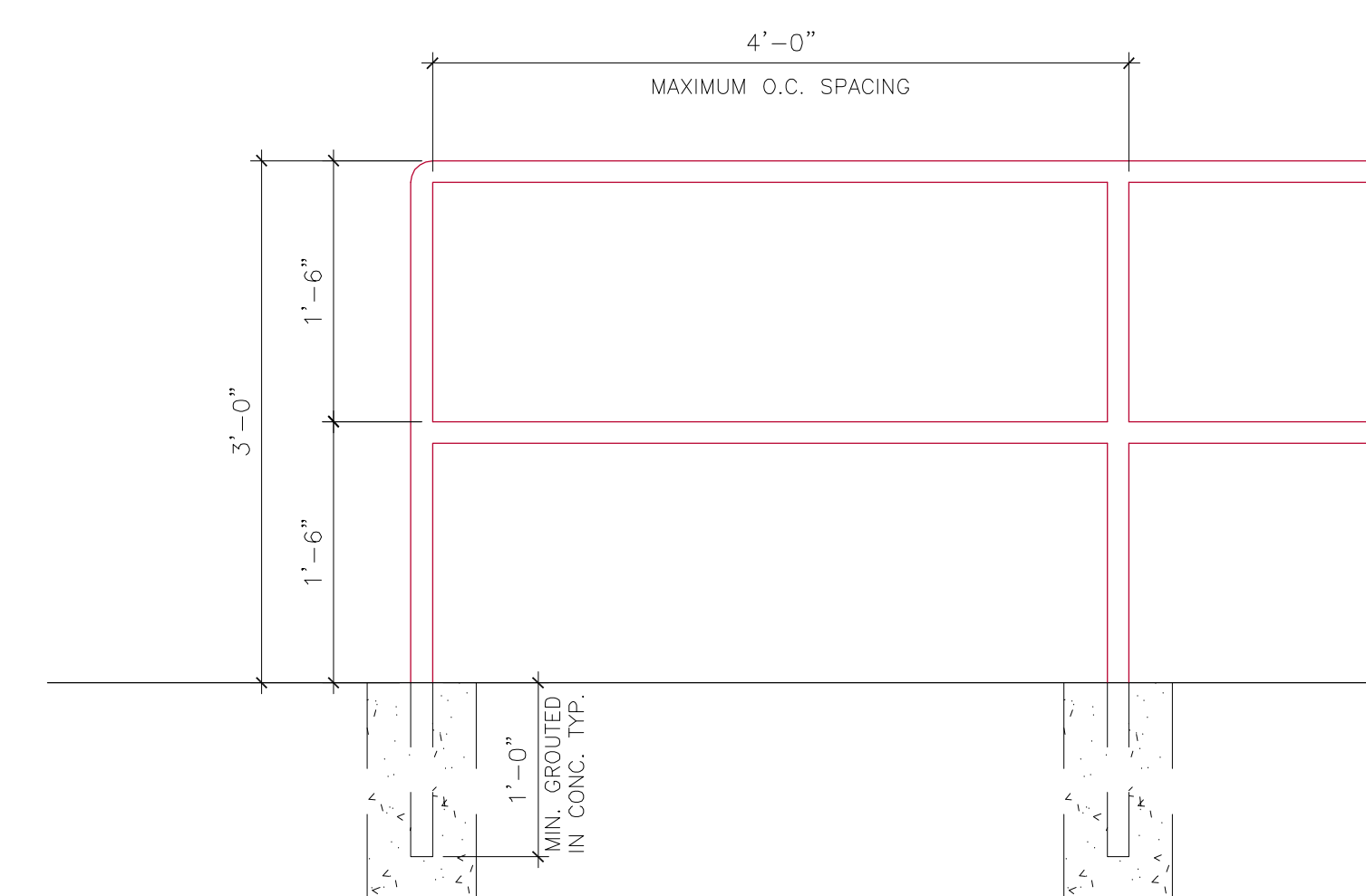

- NOTES
- ALL RAILS SHALL BE 1 1/2" DIA. HOT DIPPED GALV. TUBE RAILING.
 - CONTRACTOR SHALL PROVIDE ADD ALTERNATE PRICING TO PROVIDE 1 1/2" DIA. STAINLESS STEEL RAILS IN LIEU OF HOT DIPPED GALV.

5 TYPICAL RAILING DETAIL

Revisions

8/20/2010	ISSUED TO CLIENT
2/28/2011	ISSUED FOR BID

The Geddiss Partnership
 Architecture Planning Interiors
 71 Old Post Road, Southport, CT 06890
 (203) 256-8700

Project

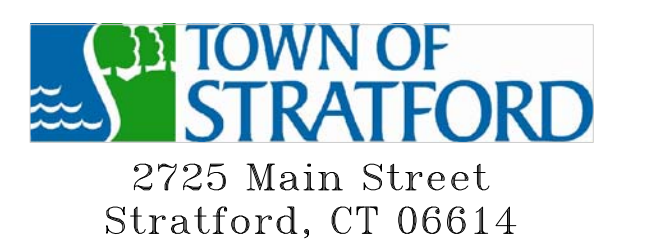

New Railings at:
Wilcoxson Elementary School
 600 Wilcoxson Avenue
 Stratford, CT 06614

Drawing Title

PLANS, ELEVATIONS, AND DETAILS

Issued	2/28/2011	Drawing No.	A-1
Scale	AS INDICATED	Job No.	
		6400.1021	