



**TOWN OF STRATFORD
PURCHASING DEPARTMENT
STRATFORD, CONNECTICUT**

BID No. 2009-018

Issued : March 3, 2009

Subject : Playground Equipment Installation

The Town of Stratford through the Office of the Purchasing Agent, will receive SEALED BIDS for furnishing the equipment described in the accompanying specifications, in accordance with the instructions, conditions and reservations that follow:

A. CLOSING DATE:

Bids will be received until 4:00 pm March 17, 2009, at which time they will be publicly opened and read. All bidders are invited to attend this public opening, which will be held immediately following the closing time specified above, in the Office of the Purchasing Agent, Room 202, Town Hall, 2725 Main Street, Stratford, CT 06615.

Any bid may be withdrawn prior to the above-scheduled time for receiving bids or authorized postponement thereof. Any bids received after the date and time specified shall NOT be considered. No bidder may withdraw a bid within 45 days after the actual opening thereof.

B. INSTRUCTIONS:

All proposals must be addressed to the attention of the Purchasing Agent, in a sealed envelope with bid subject and number on the face thereof. Proposals may be mailed or submitted in person. FAXED PROPOSALS ARE NOT ACCEPTED.

C. CONDITIONS:

Bidders must state specifically what equipment they propose to supply, giving manufacturer's name, model number, etc. A detailed description should accompany your bid. Any exceptions to Town Specifications should be listed in your bid response.

Bid Surety:

A Certified Check, Cashier's Check or Bid Bond in the amount of \$ 1,500.00 must accompany each proposal, made payable to the Town of Stratford. No bid will be considered without this surety. Upon award or rejection of the bid, all Certified Checks or Cashier's Checks received in lieu of Bid Bonds will be returned to the bidders.

Performance Bond

No Performance Bond is required for this bid.

Insurance

A. General Liability

Occurrence limit \$1,000,000; aggregate limit \$2,000,000. The insurance carried by the proposer shall be on form CG 00 01, or equivalent. The Town of Stratford shall be named as an additional insured on the contractor's General Liability Insurance Policy with form CG 20 10 or CG 20 33, *and* CG 20 37.

B. Automobile Liability

Combined single limit of \$1,000,000. Comprehensive automobile policy to cover all owned, hired or non-owned automobiles or vehicles.

C. Workers Compensation

The proposer must have workers' compensation and employers liability insurance as required by Connecticut and federal law, plus employers liability limits of \$1,000,000 per accident, 1,000,000 disease each employee and \$1,000,000 disease policy limit.

D. Umbrella Liability

The proposer shall have a minimum coverage of \$3,000,000 excess umbrella coverage, naming the Town as additional insured.

E. Professional Liability

The proposer must maintain an Appraiser's Professional Liability Insurance policy with an occurrence limit \$1,000,000 and an aggregate limit \$2,000,000. Any deductible applicable to a claim must be noted on the certificate of insurance.

The proposer shall procure and pay for the insurance coverage described above and must maintain the indicated insurance for a period of two (2) years after completion of the contract. All policies shall provide for thirty (30) days written notice prior to cancellation, substantial change or nonrenewal. The successful bidder must file the required Performance Bond and an Insurance Certificate within two weeks of the date of notification of award. Failure or neglect to do so may be considered by the Town as proof that the proposer is unable to fulfill the contract. A current insurance certificate and a copy of the endorsement or policy wording adding the Town as Additional Insured must be in the Town's possession at all times. In addition, the selected firm shall require its subcontractors, if any, to meet the same insurance requirements and to furnish the Town with similar evidence of insurance.

In addition, the proposer shall, at all times, save, indemnify and hold harmless the Town of Stratford, its officers, agents, employees and servants from liability of any nature or kind, including costs and expenses for or on account of, any patented or copyrighted equipment, materials, articles, or processes used in the performance of this contract, or on account of any and all claims, damages, losses, litigation expense and counsel fees arising out of loss or injuries (including death) sustained by or alleged to have been sustained by the public or any persons affected by the proposer's work, or by the proposer or any subcontractor, or anyone directly or indirectly employed by them while engaged in the performance of their duties in connection with this contract.

The following information should also be covered in your bid:

Payment: Final payment will be made upon the acceptance of the completed work by an authorized representative of the Town of Stratford. NO partial payments will be made. Invoices covering the work specified herein should be forwarded to the Purchasing Department upon completion of the project.

Delivery: Please state as accurately as possible how long it will take to complete delivery after receipt of order, if you are the successful bidder.

Warranty: All proposals must state the exact nature and duration of any warranty applicable to the equipment you propose to sell to the Town.

Taxes: The Town of Stratford is exempt from all State and Federal taxes. Do not include these amounts in your quotation.

Terms: All quotations must be F.O.B. Stratford, Conn., to the department indicated.

Bid Award: The bid award will be determined by a combination of price, references and equipment proposed.

D. RESERVATIONS:

The Town of Stratford may consider informal any proposal not prepared and submitted to the Town in accordance with the provisions herein stated. The Town of Stratford reserves the right to reject any or all proposals or parts of proposals; to waive defects in same proposals; or to accept any proposal or part thereof deemed to be in the best interests of the Town of Stratford.

Michael Bonnar, Purchasing Agent

For additional information, contact Phil Handy, Parks Superintendent at 203-385-4080

SPECIFICATIONS: See next page.

Town of Stratford
BID #2009-018
Playground Equipment Installation

Specifications

PROPOSED EQUIPMENT AND LAYOUT

Plans and products offered as equals shall be submitted at the time of bid along with samples and specifications for approval.

a. For alternates or substitutions the contractor must explain how they meet or exceed the standard as specified.

b. Alternate proposals to plan must include drawings to a scale of 1" = 5' and show the dimensions of the protected area required so the town of Stratford can be assured that the alternate will fit in the area.

c. The Town of Stratford shall make the final decision regarding the equality of any alternate items proposed.

d. It is a condition of this bid that in the event the Town of Stratford shall have accepted and paid for a shipment of material supplied by the successful contractor, and shall at a later date discover that the material supplied does not conform to the standard specified, the bidder shall replace any or all of the quantity of material considered substandard. Such replacement shall be accomplished without extra charge to the Town of Stratford.

e. In the event the Contractor shall neglect or refuse to furnish the said articles or any part thereof as provided in these specifications or replace any which are rejected as stated in the preceding paragraph, the Town of Stratford is authorized and empowered to purchase these articles in conformity with this contract from such party or parties, in such quantities and in such a manner as it shall select, at the expense of the contractor.

MANUFACTURERS LIABILITY INSURANCE: Proof of Insurance must be submitted with the bid as follows:

Playground Equipment \$10,000,000

Safe-fall material \$1,000.000

MANUFACTURERS WARRANTIES

Proof of Manufacturers Warranties for equipment must be included with the bid.

CERTIFICATION OF EQUIPMENT

Contractor must submit a written statement that the play equipment meets or exceeds the CPSC Guidelines, the ASTM Standards and the intent of the American's with Disabilities Act of 1990 (A.D.A.)

SAFE FALL MATERIAL SUBMITTALS: The following items are required for the installation of safe-fall material as specified:

1. Material – Engineered wood Fiber, A certificate from a third party certification service validate a manufacturer's certification of conformance with ASTM F1292-04, Standard Specification for Impact Attenuation of Surface Systems Under and Around Playground Equipment Standard.
2. Provide from the manufacturer, a Certificate of Insurance which shall provide coverage for product liability with the limited liability of not less than \$10,000,000.
3. Provide, from the manufacturer, a written Limited Lifetime warranty on the Fibar felt geotextile fabric. Provide from the manufacturer, a written Lifetime warranty, a written five (5) year Limited Warranty (performance) from date of installation and also a three year Limited Warranty (performance) from date of installation and a three (3) year Limited Warranty (biological degradation) from date of installation.
4. **INSTALLERS WARRANTIES AND SERVICE**
A one-year warranty on installation

A minimum of two visits to the project during the warranty period; one at six months following completion and one at eleven months following completion; to inspect the installation and provide basic services such as tightening bolts, touching up paint, and leveling the surface. (This requirement does not relieve the owner of setting up a regular inspection, reporting and maintenance.)

The surrender of the installation manual and kit to the owner upon completion of the installation that includes:

- a. All installation material from the manufacturer.
- b. The special installation tools and kit provided by the manufacturer
- c. A set of touch up paint colors provided by the manufacturer
- d. Written recommendations for short and long term maintenance provided by the manufacturer

REFERENCES

Bidder shall provide at least three (3) references of accessible playgrounds built with the equipment proposed

Bidder shall provide at least three (3) references of playground installations done by his/her company within the past three years.

PRODUCT WARRANTIES

Lifetime warranty on 5" and 3-1/2" support posts covering damage due to breakage or corrosion of metal parts. Lifetime warranty covers the life of the product under normal use and proper maintenance. Warranty covers structural integrity. Warranty does not cover cosmetic issues.

Lifetime warranty on all hardware against the structural integrity of the product due to breakage or shearing which causes the product to become structurally unfit for its intended use. Lifetime warranty covers the life of the product under normal use and proper maintenance.

PLAY EQUIPMENT

Locate and install playground equipment complete as indicated within the drawings and as directed by the Town of Stratford in accordance with manufacturers written instructions and in accordance with approved shop drawings.

Manufacturer will provide Contractor with an installation guide.

SAFETY SURFACING

- Locate and install surfacing, geotextile fabric complete as indicated within the drawings and as directed by the Town of Stratford in accordance with manufacturers written instructions and in accordance with approved shop drawings.
- Excavate 16" deep by the specified width and length and remove all material from the site.
- Grade and compact subgrade until level.
- Install playground per manufacturers specifications.
- Install play curbing and handicapped accessible ramp around perimeter as shown on the plan and details.
- Install geotextile fabric over entire surface.
- Install 4" of 1-1/2 inch crushed stone over the geotextile fabric.
- Install another sheet of geotextile fabric over the entire area of crushed stone.
- Install 1'-0 foot of compacted fiber over geotextile fabric.
- Backfill the play curbing with screened topsoil and see with approved seed mixture.

For additional information, contact Phil Handy, Parks Superintendent at 203-385-4080.

**Town of Stratford
BID #2009-018**

BID SHEET

1. Complete assembly and installation of Playground unit, Game Time
"Meadow Place" # 85172 installed at **Motil Park**, on Motil Place, Stratford,
per Manufacturers specifications including site preparation and installation
of surfacing as detailed in bid package, lump sum
price_____.

2. Complete assembly and installation of Playground unit, Gametime
"Meadow Place" #85172 installed at **Wigwam Park**, Wigwam Street,
Stratford, per Manufacturers specifications including site preparation and
installation of surfacing as detailed in bid package, lump sum
price_____.

3. Complete assembly and installation of Playground unit, Gametime
"Meadow Place" #85172 installed at **Stonybrook Park**, at end of Barnum
Terrace and Beach Street, Stratford, per Manufacturers specifications
including site preparation and installation of surfacing as detailed in bid
package, lump sum price_____.

4. Complete assembly and installation of Playground unit, Gametime
"Meadow Place" #85172 installed at **High Park**, on Graham Street,
Stratford, per Manufacturers specifications including site preparation and
installation of surfacing as detailed in bid package, lump sum
price_____.

5. Complete assembly and installation of Playground unit, Gametime
"Meadow Place" #85172 installed at **Exchange Park**, Reeds Lane,
Stratford, per Manufacturers specifications including site preparation and
installation of surfacing as detailed in bid package, lump sum
price_____.

Total 1-5 _____

BIDDER NAME : _____

AUTHORIZED SIGNATURE : _____

**TOWN OF STRATFORD
BIDDER INFORMATION**

BID # 2009-018 DESCRIPTION: Playground Equipment Installation

Bidder's Name : _____

Address : _____

Phone : _____ Date : _____

Authorized Signature : _____

Printed Name : _____

Title : _____

References of playgrounds built with same equipment (at least three with contact name and phone number):

References of playgrounds built within last 3 years (at least three with contact name and phone number):

RETURN THIS FORM WITH THE BID PRICE SHEET.

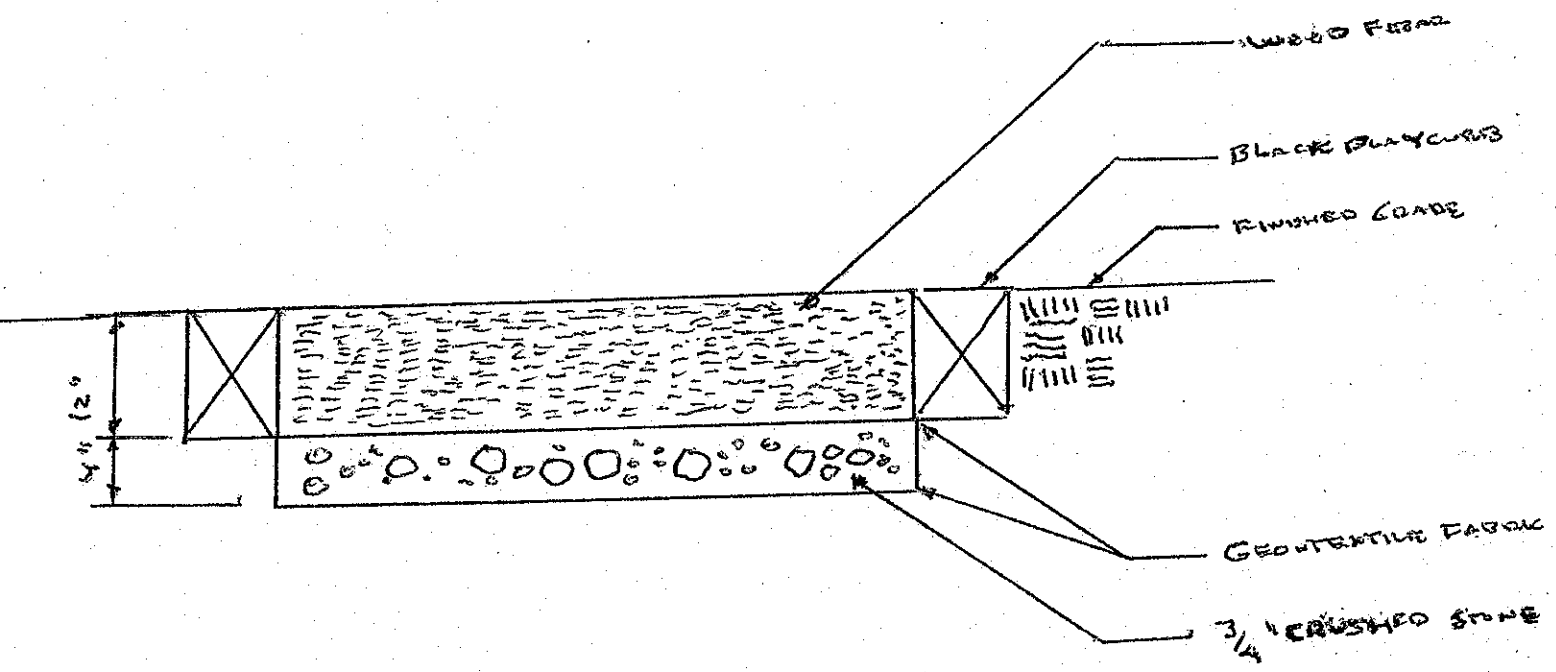

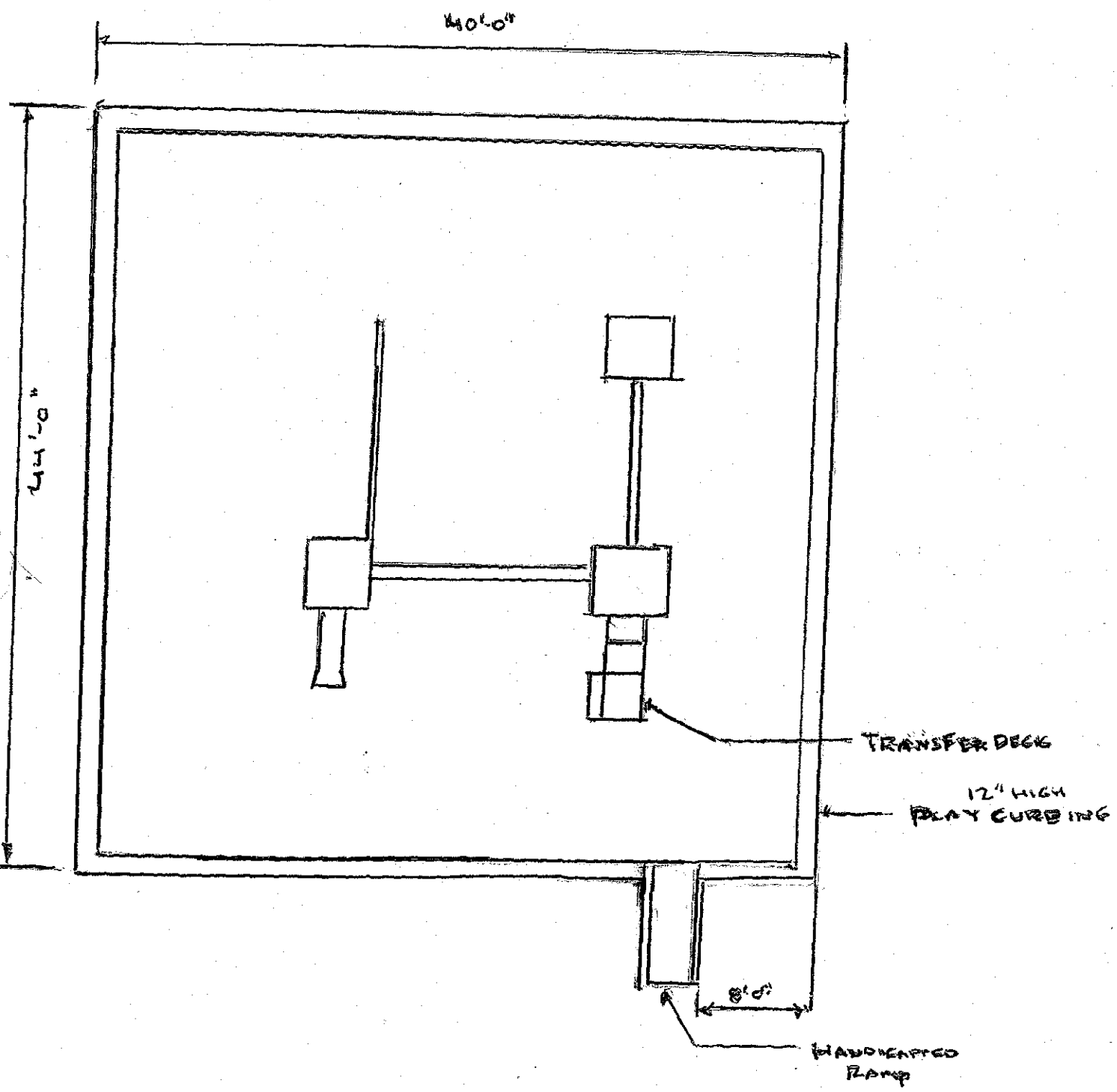

LAYOUT